

# Preco

## INSTALLATION INSTRUCTIONS 3421ETA STROBELIGHT

**DANGER! WAIT 5 MINUTES BEFORE REMOVING THE STROBE LIGHT LENS IF THE STROBE LIGHT HAS BEEN OPERATED. THE POWER SUPPLY CONTAINS LETHAL VOLTAGES WHICH MUST DISCHARGE.**

### PARTS SHOWN IN DRAWING:

1	Polycarbonate Lens, European Amber	LA3860 (with O-Ring Seal)
2	O-Ring Seal	OR3864
3	Strobe Flash Tube Assembly (Polarized)	FT3864A
4	#6-32 X 3/8" Power Supply Mounting Screw	(3 each)
5	Strobe Power Supply	PS3421
6	Aluminum Base	BP3864A
7	#10-32 X 1" SST Mounting Screw	(3 each)
8	Foam Aluminum Base Seal Gasket	FG3640
9	Wire Grommet	(1 each)
10	#10 Lockwasher	(3 each)
11	#10-32 SST Hex Nut	(3 each)
12	Wire Splice Terminal	(2 each)
15	Retaining Clip (Circuit Mosfet Transistor)	(1 each)
16	Insulating Tape (Circuit Mosfet Transistor)	(1 each)

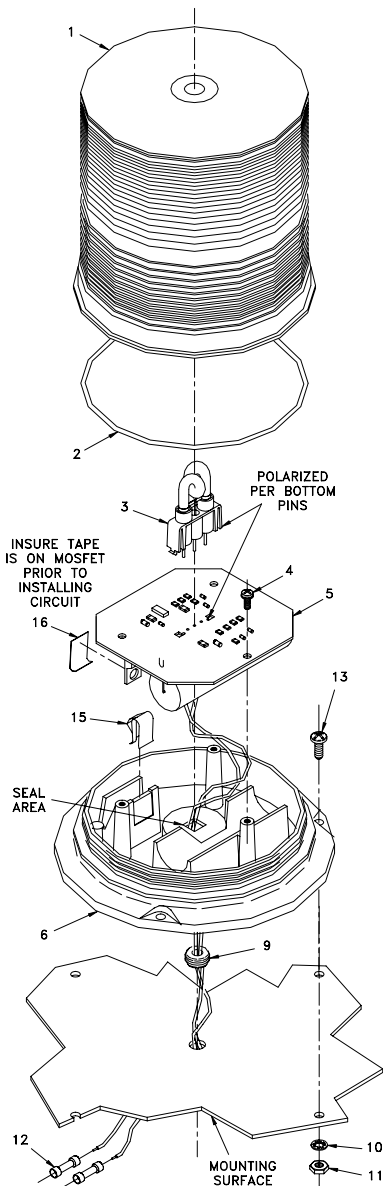

### STROBE LIGHT INSTALLATION:

The Strobe Light is intended for commercial use and should be installed and maintained by qualified personnel. Position the unit to avoid damage and protect as required. Insure the location provides for function as intended and does not interfere with operator's safe operation of the vehicle.

Use the base as a template to mark the mounting surface and drill three 5.5mm (7/32") diameter holes for the mounting screws and one 9.5mm (3/8") diameter hole in the center for the grommet. Next, route the Strobe Light wires through the Gasket and Grommet provided.

The Strobe Light can now be connected WITHOUT taking it apart. Connect the Strobe Light using 18 AWG wire for wire runs under 20 feet. For runs over 20 feet consult local electrical codes. A 10 amp fuse is recommended for wire run protection. Route the wire run in a protected fashion in accordance with the vehicle manufacturer's instructions. Connect the Red wire to Positive and the Black wire to Negative using the splice terminals provided. If this connection is reversed, the light will not operate, but will not be damaged. Test the Strobe Light operation before proceeding. Install the grommet in the mounting surface. Mount the Strobe Light on the vehicle and tighten the mounting hardware. If using another mounting method, refer to the instructions in the mounting kit. Check the Strobe Light for proper operation daily and log in the maintenance record.

### 1" NPT PIPE MOUNTING:

Feed the power leads through the pipe and connect to the Strobe Light same as the above instructions. Screw the Strobe Light onto the pipe threads, the Base is already threaded, taking care not to damage the power leads.

NOTE that 1" pipe is actually about 1-1/4" in outside diameter. If you have pipe or tubing that is actually 1" in diameter, you probably have 3/4" pipe.

### WEATHER-PROOF INSTALLATIONS:

After the Strobe Light is mounted and connected, turn OFF and WAIT 5 (FIVE) MINUTES. remove the Lens from the Base and set aside. Remove the three retaining screws and lift the Power Supply. Seal the wire exit hole in the Base with non-corrosive caulk (such as Permatex FormaGasket No. 2). Reassemble the Strobe Light. In extremely humid climates, leaving the wire exit hole unsealed may keep the inside of the unit drier than if the hole is completely sealed.

### IN CASE OF TROUBLE:

If the Strobe Light stops operating suddenly, first insure it is getting power, 16VDC min. to 36.4VDC max.. If the power to the Strobe Light is correct, then either the Flash Tube may need replacement (see below), or the internal Power Supply may need repair or replacement. To replace the Power Supply, turn OFF the Strobe Light power AND WAIT 5 (FIVE) MINUTES. Remove the lens and inspect the Flash Tube and Power Supply. If any burned or extremely corroded areas are visible, replace the Power Supply and the Flash Tube. Reassemble the Strobe Light. Always replace the Flash Tube when the Power Supply is replaced. Follow the directions below.

### REPLACEMENT OF FLASH TUBE:

The Flash Tube will darken with operation and eventually need replacement. Turn OFF the Strobe Light AND WAIT 5 (FIVE) MINUTES. Remove the Lens and set aside. Remove the Flash Tube Assembly, squeezing inward on the tabs and pulling straight upward, from the Power Supply. Do not rock the assembly or grasp the tube. Inspect the tube pins and supply sockets for corrosion, clean with isopropyl alcohol if necessary. If the corrosion is extreme, replace the Power Supply. Plug a new Flash Tube Assembly into the Power Supply, insuring tabs positively latch. Note the Tube Assembly is polarized and will only plug in one direction. Clean the inside of the Lens and the Power Supply with isopropyl alcohol. Allow parts to dry completely and reassemble insuring the Lens and O-Ring fit correctly and are assembled tightly. If necessary lubricate the O-ring with Silicone oil or grease.

**PRECO STROBE LIGHT SPECIFICATIONS**

**MODEL:** 3421ETA

**PART NO:** 694-351-4

**1.0 Introduction**

The Preco 3421ETA is a single-flash Strobe Light packaged in a durable diecast aluminum base with a removable amber lens. The modular vibration-resistant power supply and the flash-tube are both field-replaceable. This Strobe Light is designed for 24 Volt Systems without modifications or adjustment. The 3421ETA is 159mm (6-1/4") high with a base diameter of 163.5mm (6-7/16").

**2.0 Physical Specifications-see Outline Drawing**

- 2.1 Electronics: Solid-state shock-mounted PC assembly.
- 2.2 Base: Diecast Aluminum.
- 2.3 Lens: Polycarbonate lens screws onto the base.
- 2.4 Weight: 1 lb. 10 oz. (0.74 kg).
- 2.5 Size: 156.2mm (6.151") High x 162.6mm (6.400") Dia. Base.
- 2.6 Mounting: Three 5.6mm (.219") holes on a 150.9mm (5.940") diameter mounting configuration. All mounting hardware is included.

**3.0 Electrical Specifications**

- 3.1 Input Voltage: 24 Volt Systems (16.0 VDC to 36.4 VDC) for output specified in para. 4.0.
- 3.2 Input Current: 1.5 Amps typical on 24 Volt system.
- 3.3 Spike Protection: +250, -400 Volts
- 3.4 Polarity: Positive or negative ground, polarity protected.
- 3.5 Connection: Red positive, black negative 18 AWG 203mm (8") wires. Connection hardware is included.
- 3.6 Fuse Protection: Internal 5 Ampere fuse.

**4.0 Output Specifications**

- 4.1 Amber (Yellow) per European ECE 65:
- 4.2 Meets European EMI/RFI emissions/susceptability requirements per EN50082.1 and EN50082.2. Accordingly, the European CE mark is affixed on the product label.
- 4.3 SAE J1318 Apr88 Yellow Class 2 360 degree, 198 Candela-Seconds Zone Total.
- 4.4 Energy Level: 11.5 Joules.
- 4.5 Flash Rate: 125±8 single flashes per minute.

**5.0 Additional Specifications**

- 5.1 Warranty: 24 months limited warranty. Flash tube assembly 6 months limited warranty.
- 5.2 Operating Temperature Range: -30°C (-22°F) to +50°C (122°F).
- 5.3 Cleaning: Unit may be exposed to spray wash.
- 5.4 Flash-Tube and Power Supply both easily replaceable.

- 6.0 **Options:** See our catalog for a list of accessories.

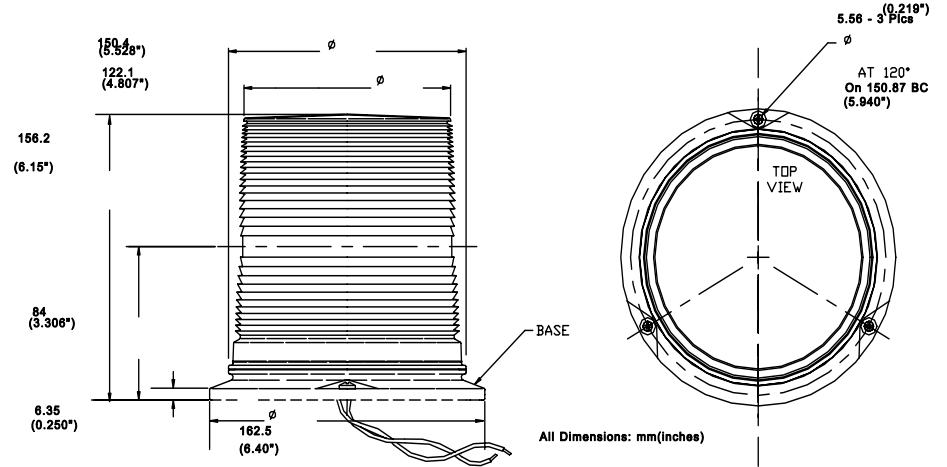

and located in the United States, Canada, or Puerto Rico.

**EXCLUSION OF OTHER WARRANTIES:** PRECO MAKES NO OTHER WARRANTIES, EXPRESS, IMPLIED OR STATUTORY. THE IMPLIED WARRANTIES FOR MERCHANTABILITY OR FITNESS FOR A PARTICULAR PURPOSE ARE HEREBY EXCLUDED AND SHALL NOT APPLY TO THE PRODUCT. BUYER'S SOLE AND EXCLUSIVE REMEDY IN CONTRACT, TORT OR UNDER ANY OTHER THEORY AGAINST PRECO RESPECTING THE PRODUCT AND ITS USE SHALL BE THE REPLACEMENT OR REPAIR OF THE PRODUCT AS DESCRIBED ABOVE.

**LIMITATION OF LIABILITY:** IN THE EVENT OF LIABILITY FOR DAMAGES ARISING OUT OF THIS LIMITED WARRANTY OR ANY OTHER CLAIM RELATED TO PRECO PRODUCTS, PRECO'S LIABILITY FOR DAMAGES SHALL BE LIMITED TO THE AMOUNT PAID FOR THE PRODUCT AT THE TIME OF ORIGINAL PURCHASE. IN NO EVENT SHALL PRECO BE LIABLE FOR LOST PROFITS, THE COST OF SUBSTITUTE EQUIPMENT OR LABOR, PROPERTY DAMAGE, OR OTHER SPECIAL, CONSEQUENTIAL OR INCIDENTAL DAMAGES BASED UPON ANY CLAIM FOR BREACH OF CONTRACT, NEGLIGENCE OR OTHER CLAIM, EVEN IF PRECO OR A PRECO REPRESENTATIVE HAS BEEN ADVISED OF THE POSSIBILITY OF SUCH DAMAGES. Preco shall have no further obligation or liability with respect to the product or its sale, operation and use, and Preco neither assumes nor authorizes the assumption of any other obligation or liability in connection with such product.

This Limited Warranty gives you specific legal rights, and you may also have other legal rights which vary from state to state. Some states do not allow the exclusion or limitation of incidental or consequential damages, so the above exclusion or limitation may not apply to you.

Any oral statements or representations about the product which may have been made by salesmen or Preco representatives do not constitute warranties. This Limited Warranty may not be amended, modified or enlarged, except by a written agreement signed by an authorized official of Preco which expressly refers to this Limited Warranty.

**PRECO LIMITED WARRANTY AND LIMITATION OF LIABILITY**

Preco warrants that on the Date of Purchase this Product will conform to Preco's published specifications for the product, which are available from Preco on request, and Preco warrants that the product is free from defects in materials and workmanship. This Limited Warranty extends for twenty four (24) months from the date of manufacture. Preco will, at its option, repair or replace any product found by Preco to be defective and subject to this Limited Warranty.

This Limited Warranty does not apply to parts or products that are misused; abused; modified; damaged by accident, fire or other hazard; improperly installed or operated; or not maintained in accordance with the maintenance procedures set forth in Preco's Installation and Operating Instructions.

To obtain warranty service, you must ship the product(s) to the specified Preco location within thirty (30) days from expiration of the warranty period. You must call for a return authorization number. You must prepay shipping charges and use the original shipping container or equivalent. Return shipping charges within the United States, Canada, and Puerto Rico will be paid by Preco. This Limited Warranty will apply only to a product purchased