

INSTALLATION INSTRUCTIONS

7600 SERIES LED ROTATING BEACON

PARTS SHOWN IN DRAWING:

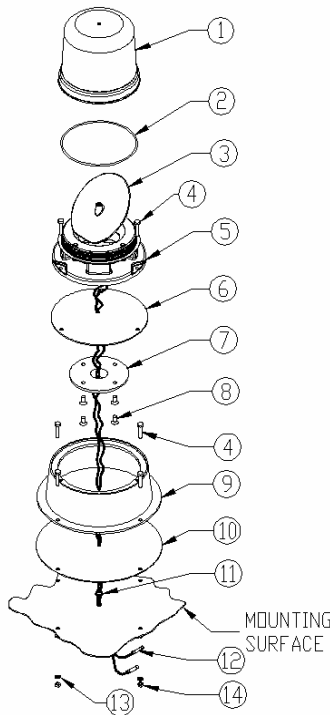

Item	Description	Kit No.
1	Polycarbonate Lens (LC7600)	(1 each)
2	O-Ring Seal (OR4200)	(1 each)
3	Rotating Elliptical Mirror	(1 each)
4	#10-32 X 1" Mounting Screw (Flush Mount Only)	(3 each / 4 each with HB4280)
4	#10-14 X 3/4" Mounting Screw (HB4280 Only)	(3 each)
5	Die-Cast Aluminum Base	(1 each)
6	Foam Die-Cast Aluminum Base Gasket (Flush Mount Only)	(1 each / FG4200)
7	1" NPT Pipe Mount Adapter (MA7600; Pipe Mount Only)	(1 each)
8	1/4"-20 X 1/2" (Pipe Mount Only)	(4 each)
9	Polycarbonate High Skirt (HB4280 Only)	(1 each)
10	Foam Polycarbonate High Skirt Gasket (HB4280 Only)	(1 each)
11	Wire Grommet	(1 each)
12	Wire Splice Terminal	(2 each)
13	#10 Lock Washer	(3 each / 4 each with HB4280)
14	#10-32 Hex Nut	(3 each / 4 each with HB4280)

LED ROTATING BEACON INSTALLATION:

The LED Rotating Beacon is intended for commercial use and should be installed and maintained by qualified personnel. Position the unit to avoid damage and protect as required. Ensure the location provides for function as intended and does not interfere with operator's safe operation of the vehicle.

- Use the Base (Item 5) as a template to mark the mounting surface and drill three 7/32" diameter holes for the Mounting Screws (Item 4) and one 3/8" diameter hole in the center for the Grommet (Item 11).
- Route 18 AWG wires, in a protected fashion, in accordance with the vehicle manufacturer's instructions, to the beacon mounting location. It is recommended to install a 10 amp slow-blow fuse in-line for wire run protection. (Note: For runs over 20 feet, consult local electrical codes.)
- Install the Grommet (Item 11) into the 3/8" hole in the mounting surface.
- Route wires through the Grommet (Item 11) and through the Gasket (Item 6).
- Connect the Beacon to the wire run using the Splice Terminals (Item 12) provided. The red wire to positive and the black wire to negative. (Note: If this connection is reversed, the light will not operate. However, it will not cause damage to the beacon.) (Note: For best performance, route the ground wire directly back to the battery.)
- Test the Beacon operation before proceeding.
- Mount the Beacon on the vehicle and tighten the mounting hardware (Item 4, 13 and 14) as shown.
- If using another mounting method, refer to the instructions with that mounting kit.

Check the Beacon for proper operation daily and log in the maintenance record.

1" NPT PIPE MOUNTING:

Attach the pipe mount adapter (Item 7) to the Base (Item 5) using the mounting hardware (Item 8). Feed the power leads through the pipe and connect to the Beacon same as the above instructions. Screw the Beacon onto the pipe threads, taking care not to damage the power leads. (Note: 1" pipe has an approximately 1-1/4" outer diameter.)

IN CASE OF TROUBLE:

If the Beacon stops operating suddenly, first ensure it is getting power (7611/7612: 9 VDC min. to 28.8 VDC max). Next, verify that the ground connection is clean and tight to the grounding surface. This will include inspecting the mounting screw and connection surface for corrosion and rust. Clean and tighten as necessary. If the power and grounding to the LED Rotating Beacon is correct, then the Beacon may need repair or replacement. Disconnect Beacon power.

PRECO LED ROTATING BEACON SPECIFICATIONS

MODEL NUMBERS: 7611A, 7611B, 7611W, 7611G, 7611R, 7612A, 7612B, 7612W, 7612G and 7612R.

1.0 Introduction:

The Preco 7600 series are rotating LED beacons. The 7600 series Beacons are packaged in a durable die-cast aluminum base with a removable lens, rotating mirror, parabolic reflector module, vibration-resistant power supply and control circuitry, stepper motor and four high power LED's. The HB4280 also allows the incorporation of a polycarbonate skirt. The 7600 series Beacons are designed for 12 and 24 Volt Systems without modifications or adjustment. The 7600 is 6.2" high with a base diameter of 6.4". The 7600 with HB4280 is 8.7" high with a skirt diameter of 8.4". Amber (SAE Yellow Amber), White (Clear), Red, Green and Blue (SAE Restricted Blue) colors are available all with a clear lens.

2.0 Physical Specifications:

- See Outline Drawing
- Electronics: Solid-state shock-mounted PCB assembly.
 - Base: Die-cast Aluminum.
 - Lens: Polycarbonate lens screws onto the base.
 - Skirt: HB4280 only, Black polycarbonate.
 - Weight: 7600, 2.3 lb. (1.1 kg).
 - Size: 7600, 6.2" (157 mm) High x 6.4" (161 mm) Dia. Base.
 - Mounting: 7600: Three 0.2" (6 mm) holes on a 5.9" (151 mm) diameter mounting configuration. All mounting hardware is included.

- 3.0 Electrical Specifications:**
- 3.1 Input Voltage: 7600: 12 & 24 Volt Systems (9.8 VDC to 28.8 VDC)
- 3.2 Input Current: 7600: Amber & Red - 1.3 Amps typical on 12 Volt system, decreasing to 0.65 Amps typical on 24 Volt system; Blue, White & Green - 1.7 Amps typical on 12 Volt system, decreasing to 0.83 Amps typical on 24 Volt system
- 3.3 Spike Protection: +150, -40 Volts.
- 3.4 Polarity: Positive or negative ground, polarity protected.
- 3.5 Connection: Red positive, black negative 18 AWG 8" wires. Connection hardware is included.
- 4.0 Output Specifications:**
- 4.1 **SAE J845 May98:** 7611 – Amber = Class 2 360°, 50 Candela*Seconds minimum required zone total. Blue = Class 1 360°, 100 Candela*Seconds minimum required zone total. White = Class 2 360°, 100 Candela*Seconds minimum required zone total. Red = Class 1 360°, 100 Candela*Seconds minimum required zone total. Green (not covered by SAE J845) = Class 1 360°, 100 Candela*Seconds minimum required zone total. **ECE 65 Dec04:** 7612 – Amber = Category T, 230 Effective Candela minimum required effective luminous intensity (0° vertical angle) by day. Blue = Category T, 120 Effective Candela minimum required effective luminous intensity (0° vertical angle) by day.
- 4.2 **SAE J578 Jul02:** 7600 - Amber, Blue, White, and Red colors conform to SAE recommended practice. **ECE 65 Dec04:** 7600 – Amber and Blue colors conform to UNECE recommended practice.
- 4.3 Flash Rate: 7611: 90 flashes per minute; 7612: 120 flashes per minute.
- 5.0 Additional Specifications:**
- 5.1 Warranty: Five (5) year limited warranty.
- 5.1 Operating Temperature Range: -30°C (-22°F) to +50°C (122°F).
- 5.2 Cleaning: Unit may be exposed to spray wash.
- 6.0 Options:**
See our catalog for a list of accessories.

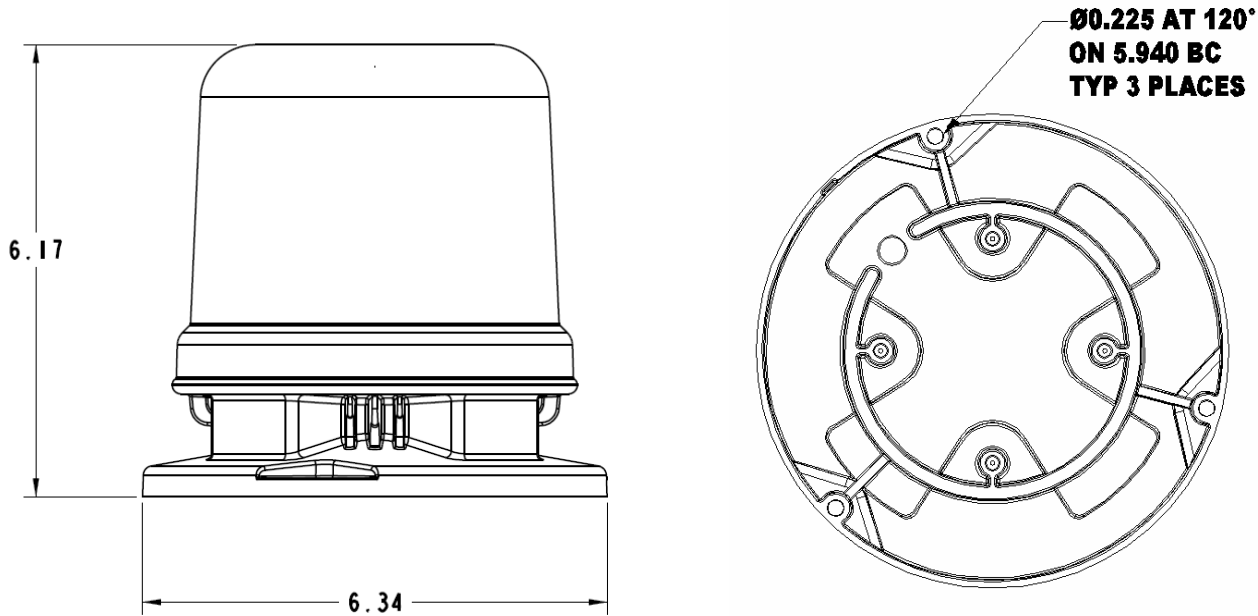

PRECO LIMITED WARRANTY AND LIMITATION OF LIABILITY

Preco warrants that on the Date of Purchase this Product will conform to Preco's published specifications for the product, which are available from Preco on request, and Preco warrants that the product is free from defects in materials and workmanship. This Limited Warranty extends for five (5) years from the date of manufacture. Preco will, at its option, repair or replace any product found by Preco to be defective and subject to this Limited Warranty.

This Limited Warranty does not apply to parts or products that are misused; abused; modified; damaged by accident, fire or other hazard; improperly installed or operated; or not maintained in accordance with the maintenance procedures set forth in Preco's Installation and Operating Instructions.

To obtain warranty service you must call Preco Customer Service at 800-453-1141 or 208-323-1010, or FAX your request to 208-323-7105. Customer Service will issue warranty authorization and further instructions.

EXCLUSION OF OTHER WARRANTIES: PRECO MAKES NO OTHER WARRANTIES, EXPRESS, IMPLIED OR STATUTORY. THE IMPLIED WARRANTIES FOR MERCHANTABILITY OR FITNESS FOR A PARTICULAR PURPOSE ARE HEREBY EXCLUDED AND SHALL NOT APPLY TO THE PRODUCT. BUYER'S SOLE AND EXCLUSIVE REMEDY IN CONTRACT, TORT OR UNDER ANY OTHER THEORY AGAINST PRECO RESPECTING THE PRODUCT AND ITS USE SHALL BE THE REPLACEMENT OR REPAIR OF THE PRODUCT AS DESCRIBED ABOVE. **LIMITATION OF LIABILITY:** IN THE EVENT OF LIABILITY FOR DAMAGES ARISING OUT OF THIS LIMITED WARRANTY OR ANY OTHER CLAIM RELATED TO PRECO PRODUCTS, PRECO'S LIABILITY FOR DAMAGES SHALL BE LIMITED TO THE AMOUNT PAID FOR THE PRODUCT AT THE TIME OF ORIGINAL PURCHASE. IN NO EVENT SHALL PRECO BE LIABLE FOR LOST PROFITS, THE COST OF SUBSTITUTE EQUIPMENT OR LABOR, PROPERTY DAMAGE, OR OTHER SPECIAL, CONSEQUENTIAL OR INCIDENTAL DAMAGES BASED UPON ANY CLAIM FOR BREACH OF CONTRACT, NEGLIGENCE OR OTHER CLAIM, EVEN IF PRECO OR A PRECO REPRESENTATIVE HAS BEEN ADVISED OF THE POSSIBILITY OF SUCH DAMAGES. Preco shall have no further obligation or liability with respect to the product or its sale, operation and use, and Preco neither assumes nor authorizes the assumption of any other obligation or liability in connection with such product.

This Limited Warranty gives you specific legal rights, and you may also have other legal rights which vary from state to state. Some states do not allow the exclusion or limitation of incidental or consequential damages, so the above exclusion or limitation may not apply to you.

Any oral statements or representations about the product which may have been made by salesmen or Preco representatives do not constitute warranties. This Limited Warranty may not be amended, modified or enlarged, except by a written agreement signed by an authorized official of Preco which expressly refers to this Limited Warranty.